

The ScreenLine® venetian blind SL20C new designed for use in double-glazed units, is manufactured in accordance with high technical specifications and production standards. The slat raising, lowering and tilting function is achieved using a rotational magnetic transmission through the glass thereby guaranteeing the unit's hermetic seal. The external magnet, fixed to the internal glass by double-sided high performance adhesive allows perfect alignment with the internal magnet, completely housed in the head rail. The raising and lowering operation is achieved using a continuous cord loop that drives the external magnet. The cord is held lightly under tension by a cord tensioner on the glass directly below the external magnet.

### Technical features

#### Magnetic drive components

Fibreglass re-inforced nylon 66 casing. Transmission gears and parts manufactured from carbon-nitride steel. Ball bearing support for both magnets and gears.

Neodymium-Iron-Boron magnets with the following technical features:

Energy produced	Bh max-Mg.Oe	33-35
Residual induction	Br-Gauss	11.000 / 12.000
Coercive force	Hc-Oestered	10.000
Maximum working temperature	°C	120
Curie temperature	°C	310
Reversible temperature factor	°C	-0.12%

#### Head rail

Extruded aluminium, A6063S-T5 alloy.

Dimensions: width 18 mm, height 41 mm with pelmet.

Includes interlocking design mechanism for easy and quick assembling of head rail to the upper U-shaped spacer bar.

Anodised or powder-painted in the same colour as the slats' or in RAL paint on request.

### **Slat**

Aluminium, AA 6011-T8 alloy. Dimensions: width 12.5 mm, thickness 0.2 mm.

High-resistance polyester paint. Available colours: five.

The slat have a special Clarion® treatment designed to eliminate possible emissions of chemical products inside the double-glazed unit, when exposed to ultraviolet and heat radiation i.e. non-fogging.

### **Bottom rail**

Extruded aluminium A6063S-T5 alloy. Dimensions: width 14 mm, height 11 mm.

Anodised or powder-painted in the same colour as the slats' or in RAL paint on request.

Manufactured in two matched profiles.

### **Ladder tape**

Thermo-fixed 100% polyester. 10 mm pitch. Excellent dimensional and colour stability to UV rays. Treated to avoid any possible emissions of chemical products inside the double-glazed unit, exposed to ultraviolet rays and heat. Same colours as slats'.

### **Cords**

Thermo-fixed 100% polyester with internal core. Excellent dimensional stability. White internal cord, 1.0 mm diameter; light grey external cord, 4 mm diameter.

### **Spacer bar**

Extruded aluminium alloy, in three possible versions:

(standard) • L-shaped 20 x 8 mm with 7 mm L

(standard) • U-shaped 20 x 8 mm with 2 mm U

(special) • U-shaped 19,5 x 6,5 mm with 2 mm U

### **Double-glazed unit size range**

Height	100~2.500 mm
Width	300~1.500 mm
Maximum area	see feasibility tables
Blind stack height	4.0% of height +45 mm

# SL20C new Comprehensive drawing with component codes

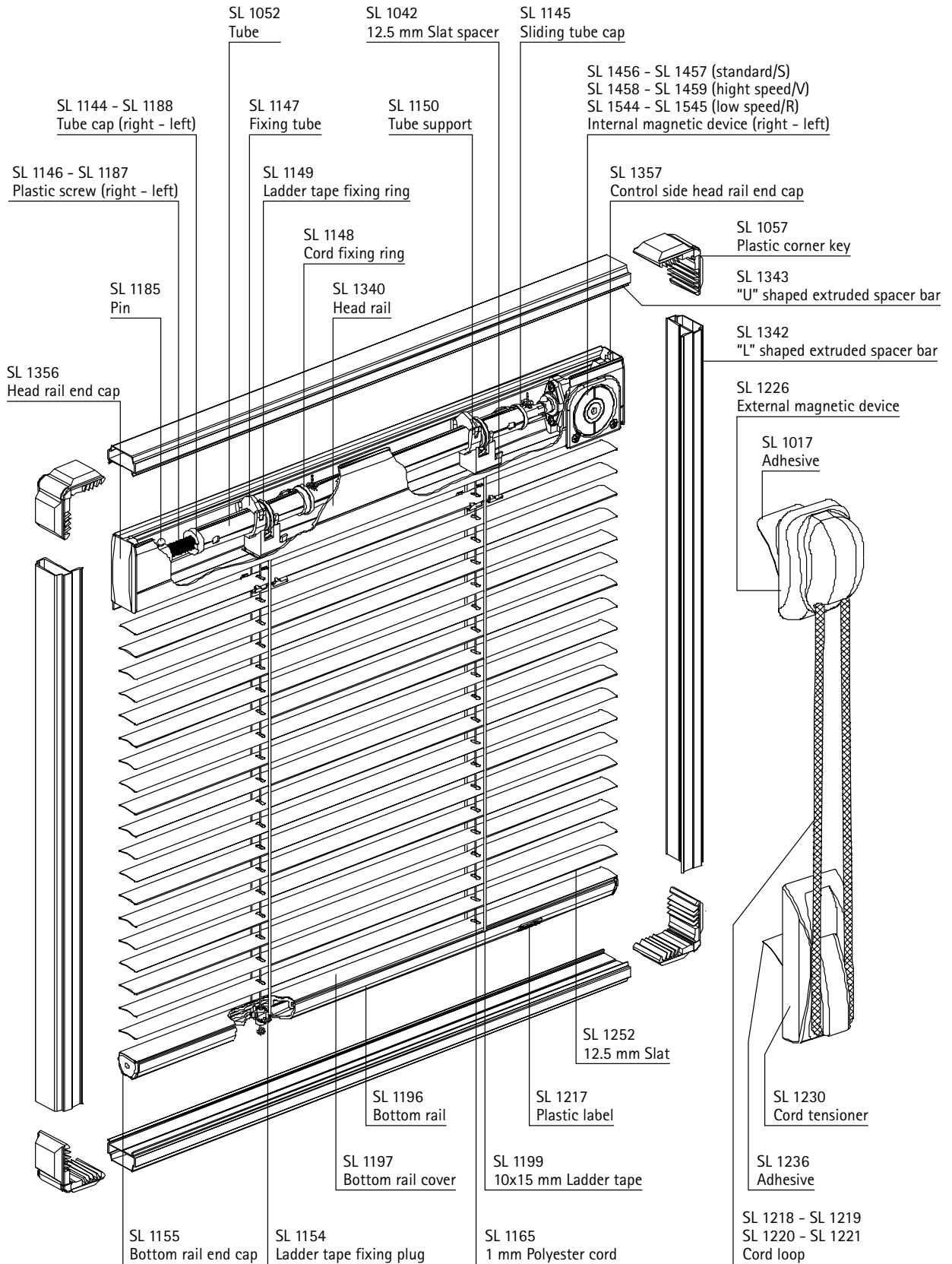

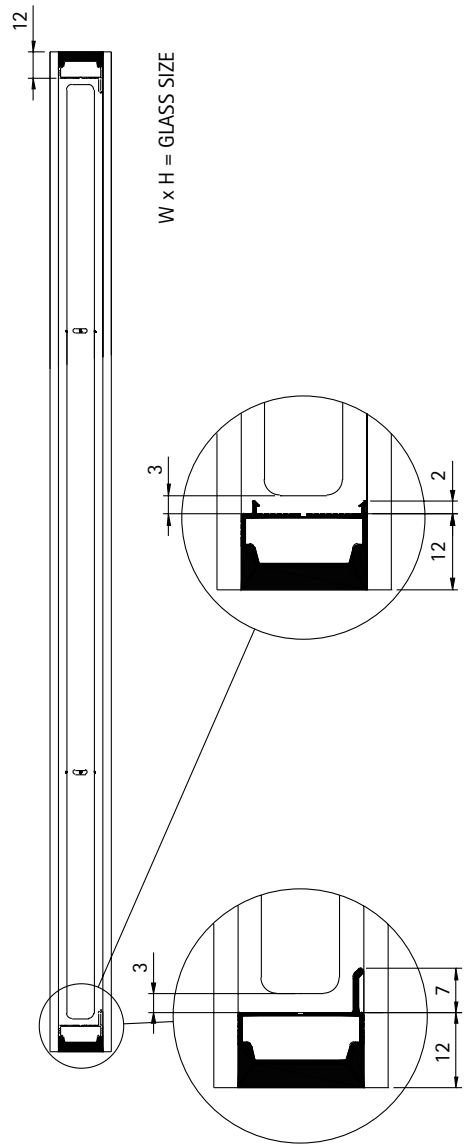
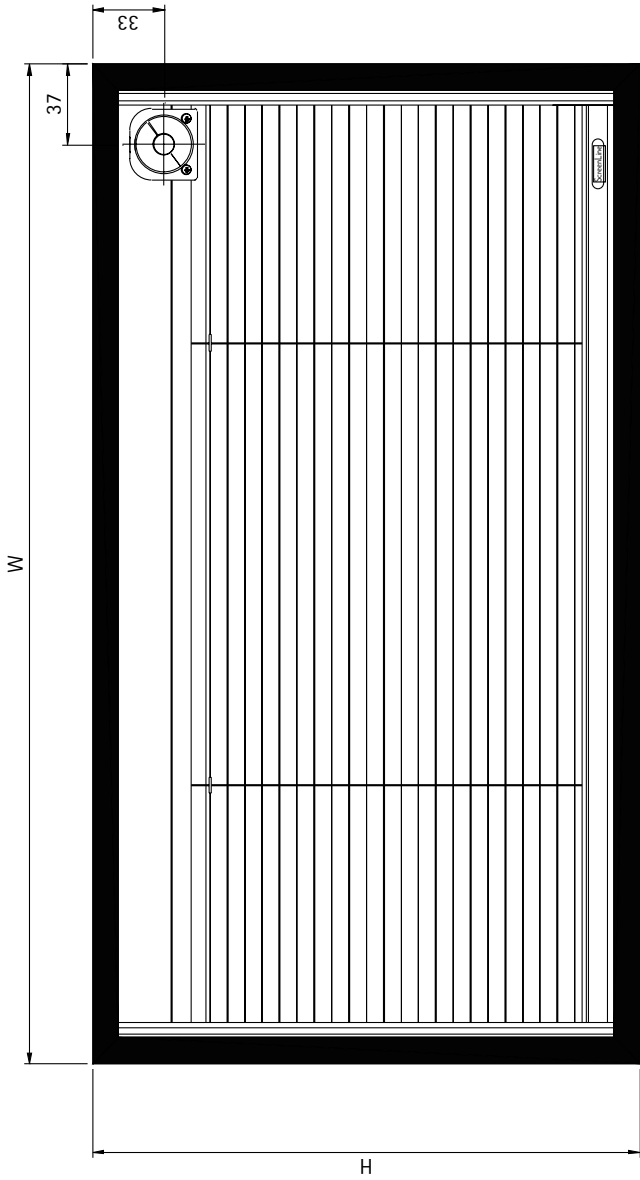
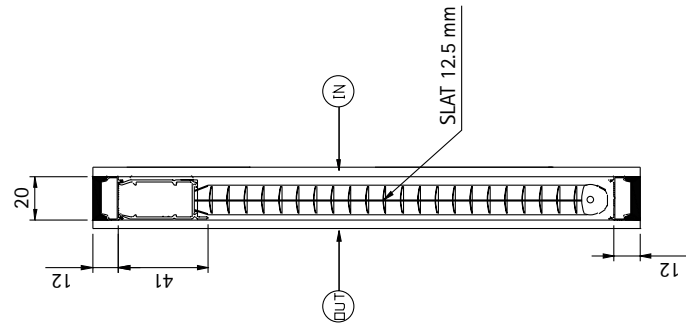

"L" SHAPED SPACER BAR (standard)

EXTRUDED SPACER BAR (option)

SL20C new

Double-glazed unit with cord operation

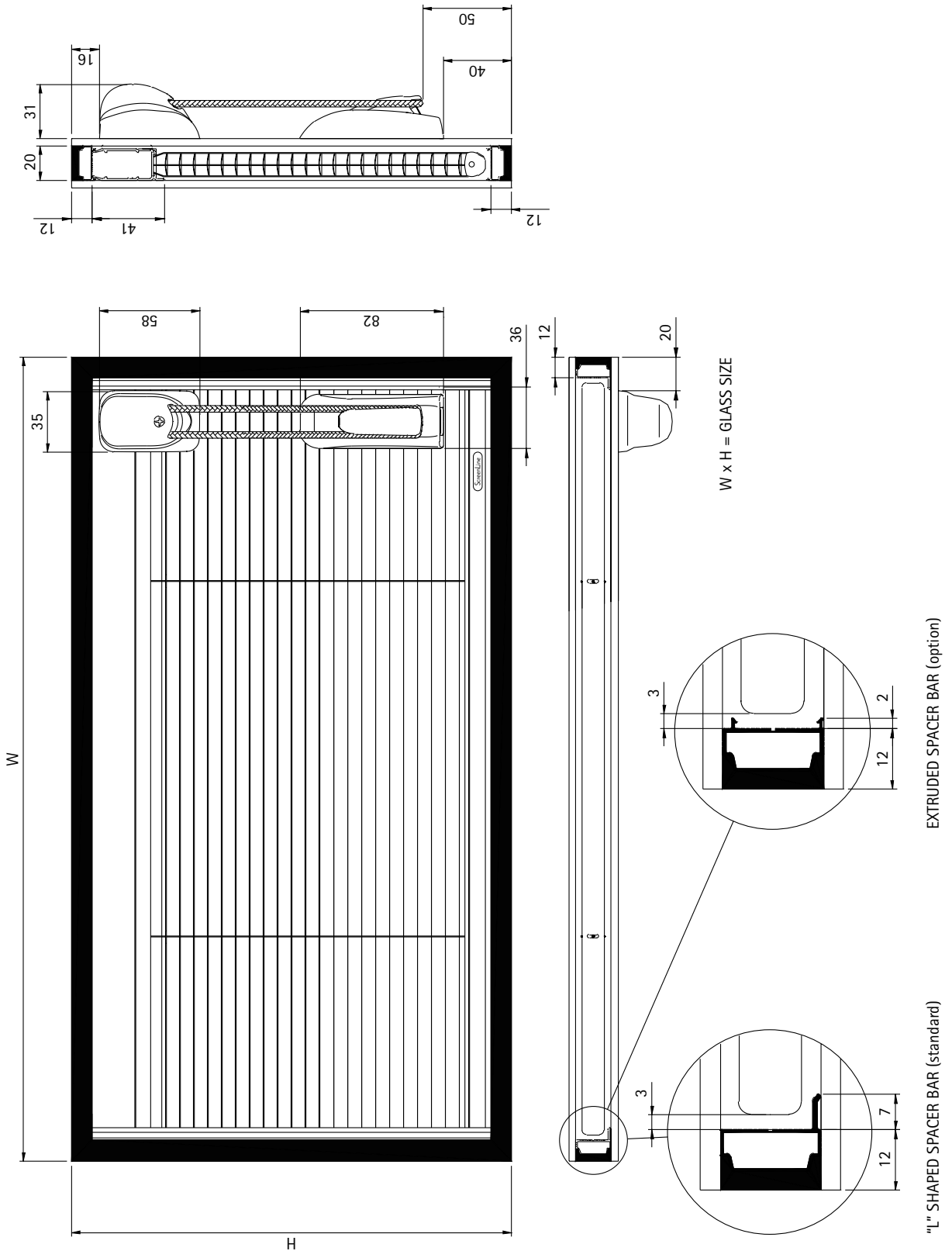

# Double-glazed unit with external motor

SL20C new

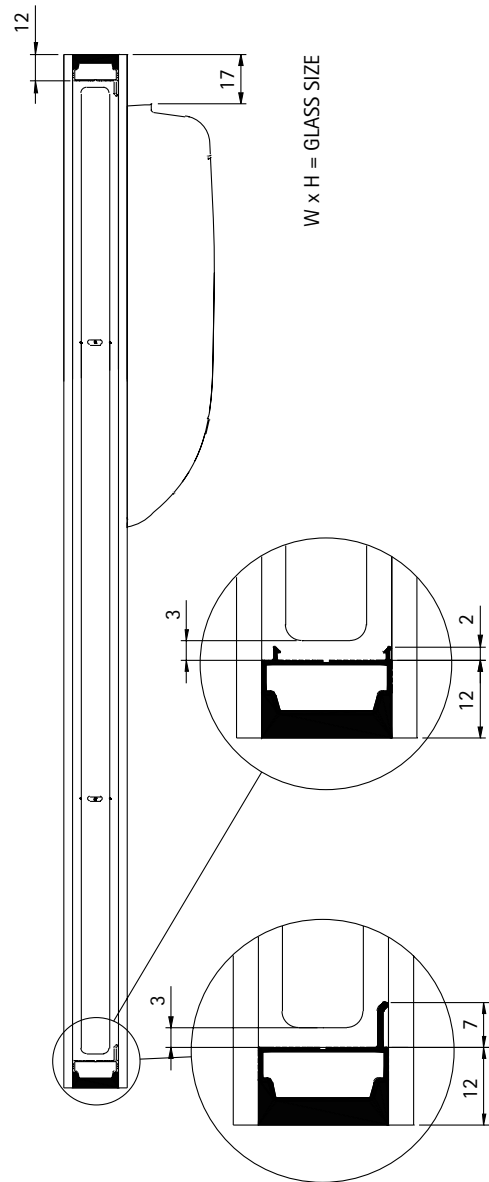
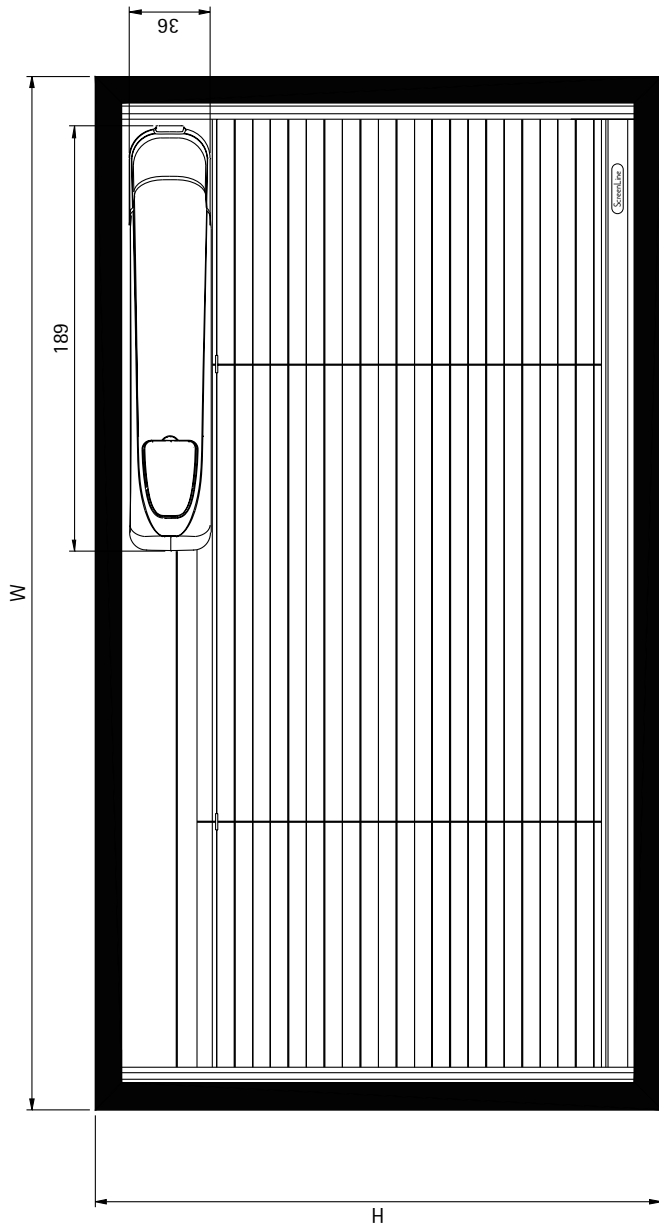
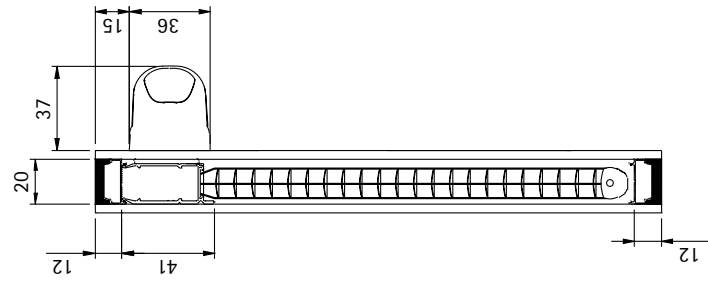

EXTRUDED SPACER BAR (option)

"L" SHAPED SPACER BAR (standard)

SL20C new

Double-glazed unit with knob operation

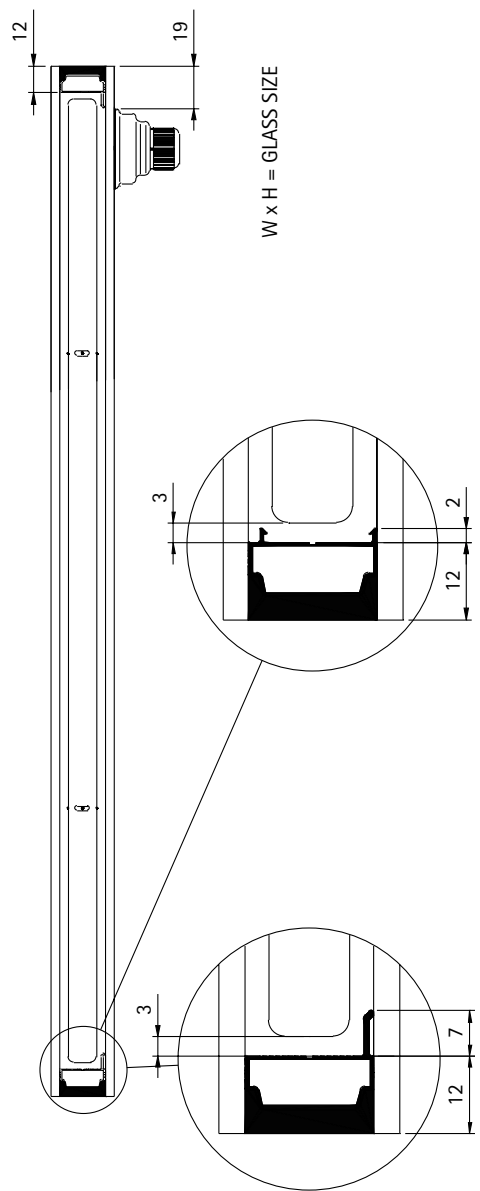
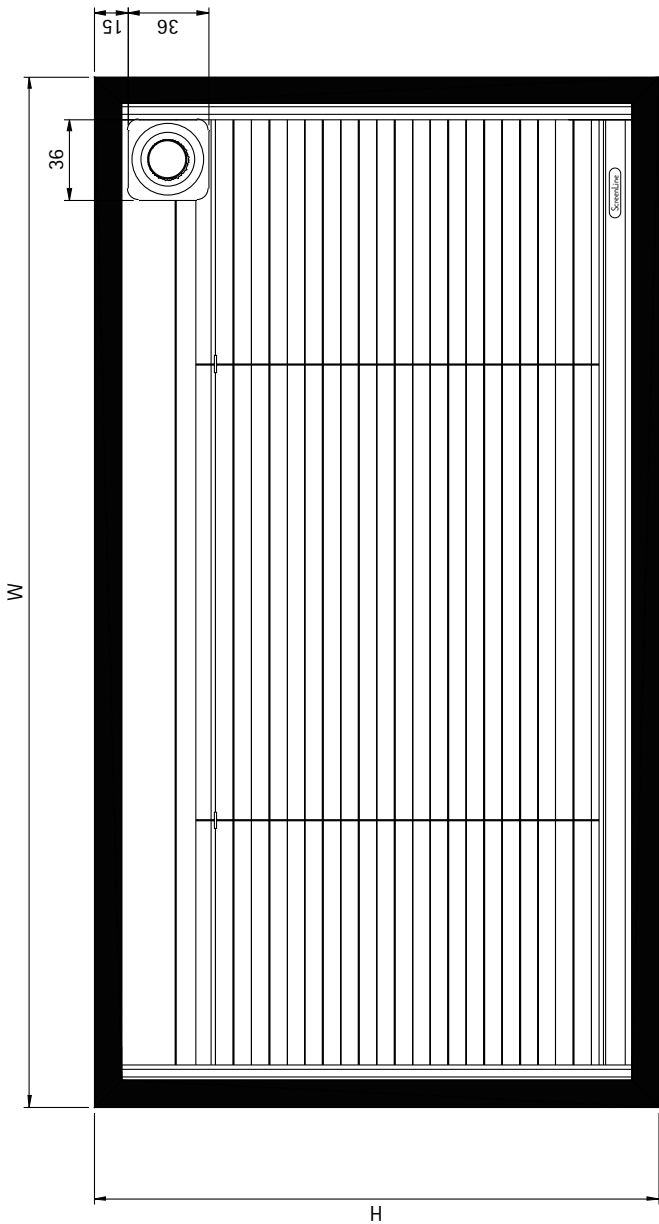
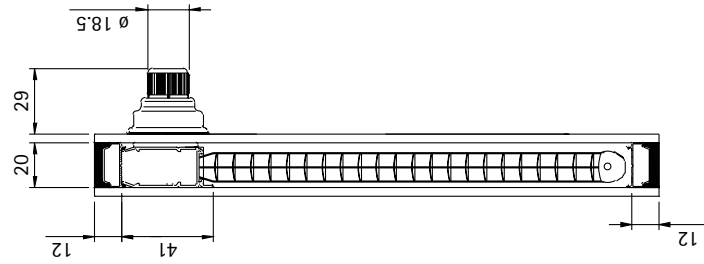

# Double-glazed unit with wand operation

SL20C new

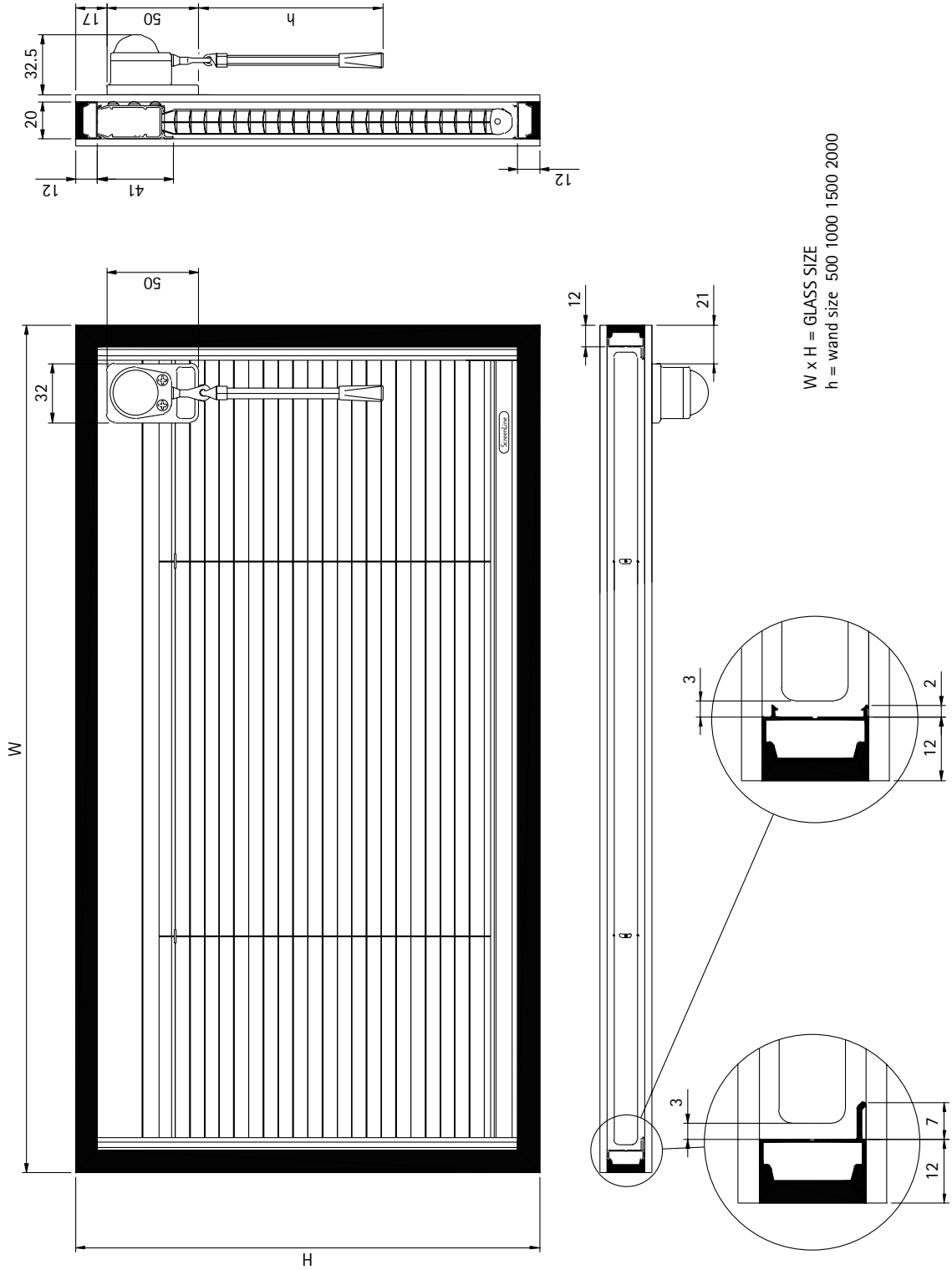





# SL20C new

## Feasibility • glass thickness 6mm (monolithic)

Height	Width																																					
	30	35	40	45	50	55	60	65	70	75	80	85	90	95	100	105	110	115	120	125	130	135	140	145	150	155	160	165	170	175	180	185	190	195	200			
30	V	V	V	V	V	V	V	V	V	V	V	V	V	V	V	V	S	S	S	S	S	S	S	S	S	S	S	S	S	S	S	S	S	S	S	S	S	
40	V	V	V	V	V	V	V	V	V	V	V	V	V	V	S	S	S	S	S	S	S	S	S	S	S	S	S	S	S	S	S	S	S	S	S	S	S	
50	V	V	V	V	V	V	V	V	V	V	V	V	V	V	S	S	S	S	S	S	S	S	S	S	S	S	S	S	S	S	S	S	S	S	S	S	S	
60	V	V	V	V	V	V	V	V	V	V	V	V	V	V	S	S	S	S	S	S	S	S	S	S	S	S	S	S	S	S	S	S	S	S	S	S	S	
70	V	V	V	V	V	V	V	V	V	V	V	V	V	V	S	S	S	S	S	S	S	S	S	S	S	S	S	S	S	S	S	S	S	S	S	S	S	
80	V	V	V	V	V	V	V	V	V	V	V	V	V	V	S	S	S	S	S	S	S	S	S	S	S	S	S	S	S	S	S	S	S	S	S	S	S	
90	V	V	V	V	V	V	V	V	V	V	V	V	V	V	S	S	S	S	S	S	S	S	S	S	S	S	S	S	S	S	S	S	S	S	S	S	S	
100	V	V	V	V	V	V	V	V	V	V	V	V	V	V	S	S	S	S	S	S	S	S	S	S	S	S	S	S	S	S	S	S	S	S	S	S	S	
110	V	V	V	V	V	V	V	V	V	V	V	V	V	V	S	S	S	S	S	S	S	S	S	S	S	S	S	S	S	S	S	S	S	S	S	S	S	
120	V	V	V	V	V	V	V	V	V	V	V	V	V	V	S	S	S	S	S	S	S	S	S	S	S	S	S	S	S	S	S	S	S	S	S	S	S	
130	V	V	V	V	V	V	V	V	V	V	V	V	V	V	S	S	S	S	S	S	S	S	S	S	S	S	S	S	S	S	S	S	S	S	S	S	S	
140	V	V	V	V	V	V	V	V	V	V	V	V	V	V	S	S	S	S	S	S	S	S	S	S	S	S	S	S	S	S	S	S	S	S	S	S	S	
150	V	V	V	V	V	V	V	V	V	V	V	V	V	V	S	S	S	S	S	S	S	S	S	S	S	S	S	S	S	S	S	S	S	S	S	S	S	
160																																						
170																																						
180																																						
190																																						
200																																						
210																																						
220																																						
230																																						
240																																						
250																																						
260																																						
270																																						

S Standard System    
  R Reduced System    
  V Speed System    
  Not-feasible    
  Out of warranty

# Feasibility • glass thickness 7 mm (laminated 3+3 mm)

# SL20C new

Height	Width																									
	30	35	40	45	50	55	60	65	70	75	80	85	90	95	100	105	110	115	120	125	130	135	140	145	150	
30	V	V	V	V	V	V	V	V	V	V	V	V	V	S	S	S	S	S	S	S	S	S	S	S	S	S
40	V	V	V	V	V	V	V	V	V	V	V	S	S	S	S	S	S	S	S	S	S	S	S	S	S	S
50	V	V	V	V	V	V	V	V	V	V	S	S	S	S	S	S	S	S	S	S	S	S	S	S	S	S
60	V	V	V	V	V	V	V	V	V	V	S	S	S	S	S	S	S	S	S	S	S	S	S	S	S	S
70	V	V	V	V	V	V	V	V	V	V	S	S	S	S	S	S	S	S	S	S	S	S	S	S	S	S
80	V	V	V	V	V	V	V	V	V	V	S	S	S	S	S	S	S	S	S	S	S	S	S	S	S	S
90	V	V	V	V	V	V	V	V	V	V	S	S	S	S	S	S	S	S	S	S	S	S	S	S	S	S
100	V	V	V	V	V	V	V	V	V	V	S	S	S	S	S	S	S	S	S	S	S	S	S	S	S	S
110	V	V	V	V	V	V	V	V	V	V	S	S	S	S	S	S	S	S	S	S	S	S	S	S	S	S
120	V	V	V	V	V	V	V	V	V	V	S	S	S	S	S	S	S	S	S	S	S	S	S	S	S	S
130	V	V	V	V	V	V	V	V	V	V	S	S	S	S	S	S	S	S	S	S	S	S	S	S	S	S
140	V	V	V	V	V	V	V	V	V	V	S	S	S	S	S	S	S	S	S	S	S	S	S	S	S	S
150	V	V	V	V	V	V	V	V	V	V	S	S	S	S	S	S	S	S	S	S	S	S	S	S	S	S
160	V	V	V	V	V	V	V	V	V	V	S	S	S	S	S	S	S	S	S	S	S	S	S	S	S	S
170	V	V	V	V	V	V	V	V	V	V	S	S	S	S	S	S	S	S	S	S	S	S	S	S	S	S
180	V	V	V	V	V	V	V	V	V	V	S	S	S	S	S	S	S	S	S	S	S	S	S	S	S	S
190	V	V	V	V	V	V	V	V	V	V	S	S	S	S	S	S	S	S	S	S	S	S	S	S	S	S
200	V	V	V	V	V	V	V	V	V	V	S	S	S	S	S	S	S	S	S	S	S	S	S	S	S	S
210	V	V	V	V	V	V	V	V	V	V	S	S	S	S	S	S	S	S	S	S	S	S	S	S	S	S
220	V	V	V	V	V	V	V	V	V	V	S	S	S	S	S	S	S	S	S	S	S	S	S	S	S	S
230	V	V	V	V	V	V	V	V	V	V	S	S	S	S	S	S	S	S	S	S	S	S	S	S	S	S
240	V	V	V	V	V	V	V	V	V	V	S	S	S	S	S	S	S	S	S	S	S	S	S	S	S	S
250	V	V	V	V	V	V	V	V	V	V	S	S	S	S	S	S	S	S	S	S	S	S	S	S	S	S
260	V	V	V	V	V	V	V	V	V	V	S	S	S	S	S	S	S	S	S	S	S	S	S	S	S	S
270	V	V	V	V	V	V	V	V	V	V	S	S	S	S	S	S	S	S	S	S	S	S	S	S	S	S

S Standard System    
  R Reduced System    
  V Speed System    
  Not-feasible    
  Out of warranty

# SL20C new

## Feasibility • glass thickness 8mm (monolithic)

Height	Width	30	35	40	45	50	55	60	65	70	75	80	85	90	95	100	105	110	115	120	125	130	135	140	145	150	155	160	165	170	175	180	185	190	195	200		
		L	V	V	V	V	V	V	V	V	V	S	S	S	S	S	S	S	S	S	S	S	S	S	S	S	S	S	S	S	S	S	S	S	S	S	S	S
30	V	V	V	V	V	V	V	V	V	V	S	S	S	S	S	S	S	S	S	S	S	S	S	S	S	S	S	S	S	S	S	S	S	S	S	S	S	
40	V	V	V	V	V	V	V	V	V	V	S	S	S	S	S	S	S	S	S	S	S	S	S	S	S	S	S	S	S	S	S	S	S	S	S	S	S	S
50	V	V	V	V	V	V	V	V	V	V	S	S	S	S	S	S	S	S	S	S	S	S	S	S	S	S	S	S	S	S	S	S	S	S	S	S	S	S
60	V	V	V	V	V	V	V	V	V	V	S	S	S	S	S	S	S	S	S	S	S	S	S	S	S	S	S	S	S	S	S	S	S	S	S	S	S	S
70	V	V	V	V	V	V	V	V	V	V	S	S	S	S	S	S	S	S	S	S	S	S	S	S	S	S	S	S	S	S	S	S	S	S	S	S	S	S
80	V	V	V	V	V	V	V	V	V	V	S	S	S	S	S	S	S	S	S	S	S	S	S	S	S	S	S	S	S	S	S	S	S	S	S	S	S	S
90	V	V	V	V	V	V	V	V	V	V	S	S	S	S	S	S	S	S	S	S	S	S	S	S	S	S	S	S	S	S	S	S	S	S	S	S	S	S
100	V	V	V	V	V	V	V	V	V	V	S	S	S	S	S	S	S	S	S	S	S	S	S	S	S	S	S	S	S	S	S	S	S	S	S	S	S	S
110	V	S	S	S	S	S	S	S	S	S	S	S	S	S	S	S	R	R	R	R	R	R	R	R	R	R	R	R	R	R	R	R	R	R	R	R	R	
120	V	S	S	S	S	S	S	S	S	S	S	S	S	S	S	R	R	R	R	R	R	R	R	R	R	R	R	R	R	R	R	R	R	R	R	R	R	
130	S	S	S	S	S	S	S	S	S	S	S	S	S	S	S	R	R	R	R	R	R	R	R	R	R	R	R	R	R	R	R	R	R	R	R	R	R	
140	S	S	S	S	S	S	S	S	S	S	S	S	S	S	R	R	R	R	R	R	R	R	R	R	R	R	R	R	R	R	R	R	R	R	R	R	R	
150	S	S	S	S	S	S	S	S	S	S	S	S	S	S	R	R	R	R	R	R	R	R	R	R	R	R	R	R	R	R	R	R	R	R	R	R	R	
160	S	S	S	S	S	S	S	S	S	S	S	S	S	S	R	R	R	R	R	R	R	R	R	R	R	R	R	R	R	R	R	R	R	R	R	R	R	
170	S	S	S	S	S	S	S	S	S	S	S	S	S	S	R	R	R	R	R	R	R	R	R	R	R	R	R	R	R	R	R	R	R	R	R	R	R	
180	S	S	S	S	S	S	S	S	S	S	S	S	S	S	R	R	R	R	R	R	R	R	R	R	R	R	R	R	R	R	R	R	R	R	R	R	R	
190	S	S	S	S	S	S	S	S	S	S	S	S	S	S	R	R	R	R	R	R	R	R	R	R	R	R	R	R	R	R	R	R	R	R	R	R	R	
200	S	S	S	S	S	S	S	S	S	S	S	S	S	S	R	R	R	R	R	R	R	R	R	R	R	R	R	R	R	R	R	R	R	R	R	R	R	
210	S	S	S	S	S	S	S	S	S	S	S	S	S	S	R	R	R	R	R	R	R	R	R	R	R	R	R	R	R	R	R	R	R	R	R	R	R	
220	S	S	S	S	S	S	S	S	S	S	S	S	S	S	R	R	R	R	R	R	R	R	R	R	R	R	R	R	R	R	R	R	R	R	R	R	R	
230	S	S	S	S	S	S	S	S	S	S	S	S	S	S	R	R	R	R	R	R	R	R	R	R	R	R	R	R	R	R	R	R	R	R	R	R	R	
240	S	S	S	S	S	S	S	S	S	S	S	S	S	S	R	R	R	R	R	R	R	R	R	R	R	R	R	R	R	R	R	R	R	R	R	R	R	
250	S	S	S	S	S	S	S	S	S	S	S	S	S	S	R	R	R	R	R	R	R	R	R	R	R	R	R	R	R	R	R	R	R	R	R	R	R	
260	S	S	S	S	S	S	S	S	S	S	S	S	S	S	R	R	R	R	R	R	R	R	R	R	R	R	R	R	R	R	R	R	R	R	R	R	R	
270	S	S	S	S	S	S	S	S	S	S	S	S	S	S	R	R	R	R	R	R	R	R	R	R	R	R	R	R	R	R	R	R	R	R	R	R	R	

S Standard System    
  R Reduced System    
  V Speed System    
  Not-feasible    
  Out of warranty

Feasibility • glass thickness 9mm (laminated 4+4 mm)

SL20C new

Height	30	35	40	45	50	55	60	65	70	75	80	85	90	95	100	105	110	115	120	125	130	135	140	145	150
30	V	V	V	V	V	V	V	S	S	S	S	S	S	S	S	S	S	S	S	S	S	S	S	S	S
40	V	V	V	V	V	S	S	S	S	S	S	S	S	S	S	S	S	S	S	S	S	S	S	S	S
50	V	V	V	V	S	S	S	S	S	S	S	S	S	S	S	S	S	S	S	S	S	S	S	S	S
60	V	V	V	S	S	S	S	S	S	S	S	S	S	S	S	S	S	S	S	S	S	S	S	S	S
70	V	V	S	S	S	S	S	S	S	S	S	S	S	S	S	S	S	S	S	S	S	S	S	S	S
80	V	S	S	S	S	S	S	S	S	S	S	S	S	S	S	S	S	S	S	S	S	S	S	S	S
90	S	S	S	S	S	S	S	S	S	S	S	S	S	S	S	S	S	S	S	S	S	S	S	S	S
100	S	S	S	S	S	S	S	S	S	S	S	S	S	S	S	S	S	S	S	S	S	S	S	S	S
110	S	S	S	S	S	S	S	S	S	S	S	S	S	S	S	S	S	S	S	S	S	S	S	S	S
120	S	S	S	S	S	S	S	S	S	S	S	S	S	S	S	S	S	S	S	S	S	S	S	S	S
130	S	S	S	S	S	S	S	S	S	S	S	S	S	S	S	S	S	S	S	S	S	S	S	S	S
140	S	S	S	S	S	S	S	S	S	S	S	S	S	S	S	S	S	S	S	S	S	S	S	S	S
150	S	S	S	S	S	S	S	S	S	S	S	S	S	S	S	S	S	S	S	S	S	S	S	S	S
160	S	S	S	S	S	S	S	S	S	S	S	S	S	S	S	S	S	S	S	S	S	S	S	S	S
170	S	S	S	S	S	S	S	S	S	S	S	S	S	S	S	S	S	S	S	S	S	S	S	S	S
180	S	S	S	S	S	S	S	S	S	S	S	S	S	S	S	S	S	S	S	S	S	S	S	S	S
190	S	S	S	S	S	S	S	S	S	S	S	S	S	S	S	S	S	S	S	S	S	S	S	S	S
200	S	S	S	S	S	S	S	S	S	S	S	S	S	S	S	S	S	S	S	S	S	S	S	S	S
210	S	S	S	S	S	S	S	S	S	S	S	S	S	S	S	S	S	S	S	S	S	S	S	S	S
220	S	S	S	S	S	S	S	S	S	S	S	S	S	S	S	S	S	S	S	S	S	S	S	S	S
230	S	S	S	S	S	S	S	S	S	S	S	S	S	S	S	S	S	S	S	S	S	S	S	S	S
240	S	S	S	S	S	S	S	S	S	S	S	S	S	S	S	S	S	S	S	S	S	S	S	S	S
250	S	S	S	S	S	S	S	S	S	S	S	S	S	S	S	S	S	S	S	S	S	S	S	S	S
260	S	S	S	S	S	S	S	S	S	S	S	S	S	S	S	S	S	S	S	S	S	S	S	S	S
270	S	S	S	S	S	S	S	S	S	S	S	S	S	S	S	S	S	S	S	S	S	S	S	S	S

Standard System    
  Reduced System    
  Speed System    
  Not-feasible    
  Out of warranty

# SL20C new

## Feasibility • glass thickness 10mm (monolithic)

Height	30	35	40	45	50	55	60	65	70	75	80	85	90	95	100	105	110	115	120	125	130	135	140	145	150	155	160	165	170	175	180	185	190	195	200			
30	V	V	V	V	S	S	S	S	S	S	S	S	S	S	S	S	S	S	S	S	S	R	R	R	R	R	R	R	R	R	R	R	R	R	R	R		
40	V	V	S	S	S	S	S	S	S	S	S	S	S	S	S	S	S	S	S	S	S	R	R	R	R	R	R	R	R	R	R	R	R	R	R	R	R	
50	V	S	S	S	S	S	S	S	S	S	S	S	S	S	S	S	S	S	S	S	S	R	R	R	R	R	R	R	R	R	R	R	R	R	R	R	R	
60	S	S	S	S	S	S	S	S	S	S	S	S	S	S	S	S	S	S	S	S	S	R	R	R	R	R	R	R	R	R	R	R	R	R	R	R	R	
70	S	S	S	S	S	S	S	S	S	S	S	S	S	S	S	S	S	S	S	S	S	R	R	R	R	R	R	R	R	R	R	R	R	R	R	R	R	
80	S	S	S	S	S	S	S	S	S	S	R	R	R	R	R	R	R	R	R	R	R	R	R	R	R	R	R	R	R	R	R	R	R	R	R	R	R	
90	S	S	S	S	S	S	S	S	S	S	R	R	R	R	R	R	R	R	R	R	R	R	R	R	R	R	R	R	R	R	R	R	R	R	R	R	R	
100	S	S	S	S	S	S	S	S	R	R	R	R	R	R	R	R	R	R	R	R	R	R	R	R	R	R	R	R	R	R	R	R	R	R	R	R	R	
110	S	S	S	S	S	S	S	S	R	R	R	R	R	R	R	R	R	R	R	R	R	R	R	R	R	R	R	R	R	R	R	R	R	R	R	R	R	
120	S	S	S	S	S	S	S	S	R	R	R	R	R	R	R	R	R	R	R	R	R	R	R	R	R	R	R	R	R	R	R	R	R	R	R	R	R	
130	S	S	S	S	S	S	S	S	R	R	R	R	R	R	R	R	R	R	R	R	R	R	R	R	R	R	R	R	R	R	R	R	R	R	R	R	R	
140	S	S	S	S	S	S	S	S	R	R	R	R	R	R	R	R	R	R	R	R	R	R	R	R	R	R	R	R	R	R	R	R	R	R	R	R	R	R
150	S	S	S	S	S	S	S	S	R	R	R	R	R	R	R	R	R	R	R	R	R	R	R	R	R	R	R	R	R	R	R	R	R	R	R	R	R	R
160	S	S	S	S	S	S	S	S	R	R	R	R	R	R	R	R	R	R	R	R	R	R	R	R	R	R	R	R	R	R	R	R	R	R	R	R	R	
170	S	S	S	S	S	S	S	S	R	R	R	R	R	R	R	R	R	R	R	R	R	R	R	R	R	R	R	R	R	R	R	R	R	R	R	R	R	
180	S	S	S	S	S	S	S	S	R	R	R	R	R	R	R	R	R	R	R	R	R	R	R	R	R	R	R	R	R	R	R	R	R	R	R	R	R	
190	S	S	S	S	S	S	S	S	R	R	R	R	R	R	R	R	R	R	R	R	R	R	R	R	R	R	R	R	R	R	R	R	R	R	R	R	R	
200	S	S	S	R	R	R	R	R	R	R	R	R	R	R	R	R	R	R	R	R	R	R	R	R	R	R	R	R	R	R	R	R	R	R	R	R	R	
210	S	S	S	R	R	R	R	R	R	R	R	R	R	R	R	R	R	R	R	R	R	R	R	R	R	R	R	R	R	R	R	R	R	R	R	R	R	
220	S	S	S	R	R	R	R	R	R	R	R	R	R	R	R	R	R	R	R	R	R	R	R	R	R	R	R	R	R	R	R	R	R	R	R	R	R	
230	S	S	S	R	R	R	R	R	R	R	R	R	R	R	R	R	R	R	R	R	R	R	R	R	R	R	R	R	R	R	R	R	R	R	R	R	R	
240	S	S	S	R	R	R	R	R	R	R	R	R	R	R	R	R	R	R	R	R	R	R	R	R	R	R	R	R	R	R	R	R	R	R	R	R	R	
250	S	S	S	R	R	R	R	R	R	R	R	R	R	R	R	R	R	R	R	R	R	R	R	R	R	R	R	R	R	R	R	R	R	R	R	R	R	
260																																						
270																																						

S Standard System    
  R Reduced System    
  V Speed System    
  Not-feasible    
  Out of warranty

### ScreenLine® kit components

On receipt of goods, check the integrity of the package and confirm components are as detailed on the Purchase Order. The kit includes **A** :

- venetian blind with head rail (mechanical fix)
- 2 No. U-profile spacer bar (width)
- 2 No. L-profile spacer bar (height)
- 4 No. Plastic corner keys
- external magnet with cord and cord tensioner, both with factory applied adhesive tape.

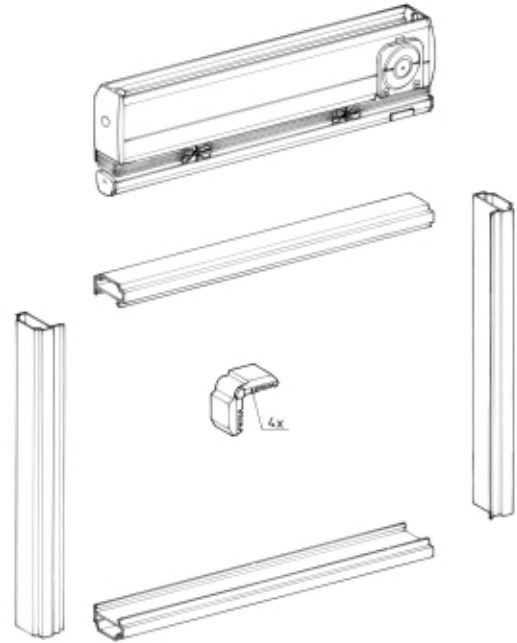

**A** Kit

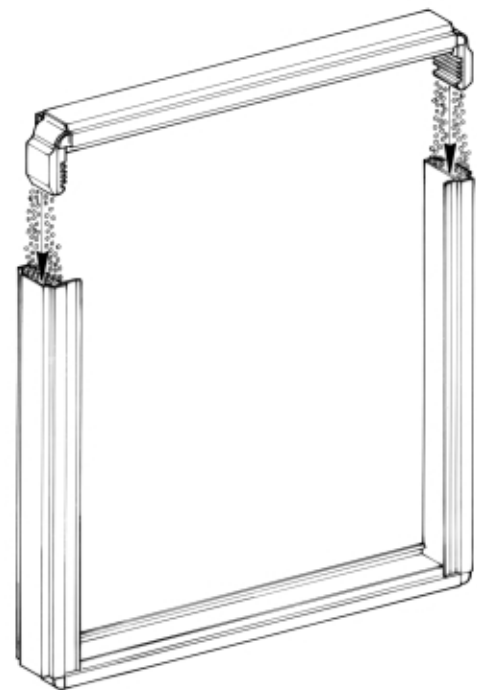

**B** Dessicant filling

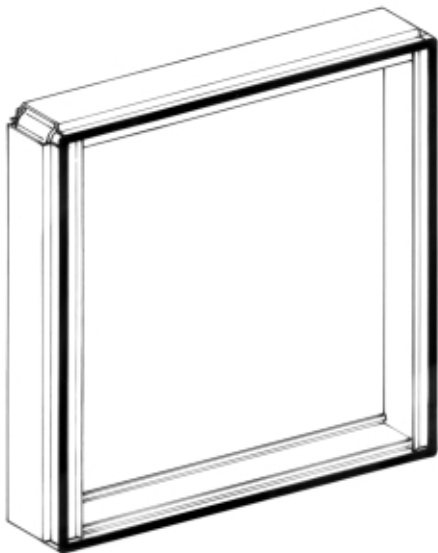

**C** Butyl application

## Assembly of integral blind unit

### Spacer bars preparation

Fill the spacer bars with molecular sieve **B** and extrude a continuous primary seal of hot butyl on them **C**. Ensure that the fin of the L-shaped spacer bar faces the free space on the U-shaped spacer bar. (See Manufacturer's quality scheme, page 38).

### Line assembly

Remove the plastic protective film from the blind, align the head-rail with the TOP spacer (U-profile) **D1** and clip together to form a mechanical seal. **D2** Use the fin of the L-shaped spacer bar as a guide support. Position the spacer frame and the attached blind onto the first glass maintaining it parallel and square. Press to obtain good adhesion. **E1** Assemble the second glass and press. **E2**

### Gas filling

Using the appropriate equipment and following the requisite procedure replace the internal air with argon.

### Testing

Prior to the final seal **F**, test the blind operation using the external magnet. For this the unit must be vertical with the head-rail horizontal at the top of the unit. During this operation check that the distance between the slats and the side spacer bars is even.

### Second sealing

Raise the blind and apply the final seal. (See Manufacturer's quality scheme, page 38). **F**

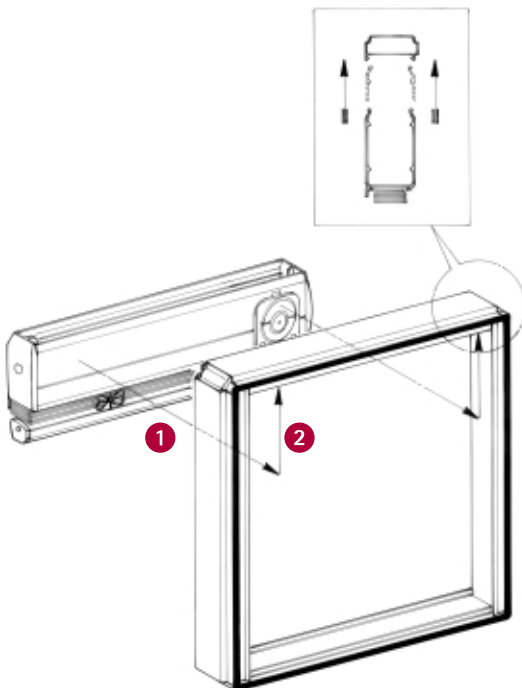

**D** Head rail spacer bar assembly

### Note

1. Always ensure that the blind is completely raised when turning the unit.
2. The external magnet and cord tensioner should only be applied to the glass surface after glazing. Please ensure the glass surface is cleaned correctly to obtain good adhesion.
3. The use of the stainless steel base plate allows greater accuracy when locating the external magnet over the internal magnet in order to achieve perfect alignment. During this operation ensure the glass is clean.

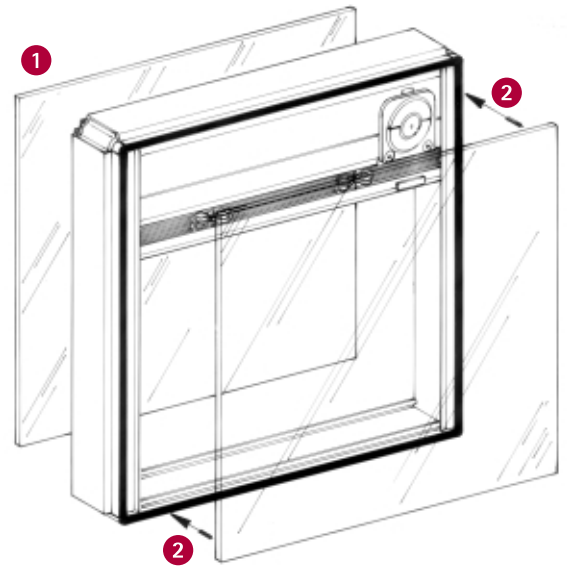

**E** D.G. unit assembly

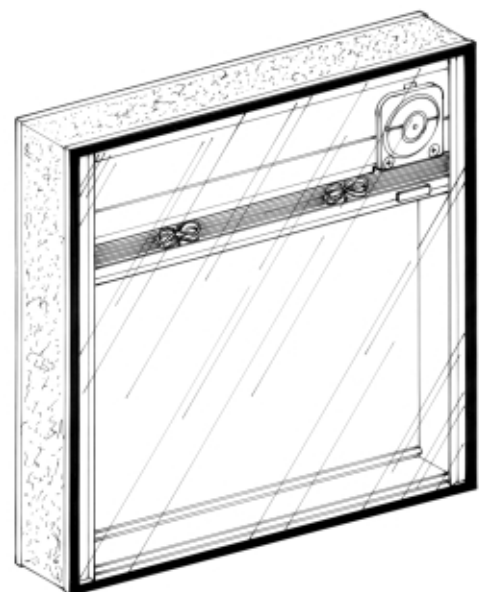

**F** D.G. unit final sealing